

The Lakewood

42 X 13 | 2 BEDROOMS
THE COVE



Your Lodge Includes

- ✓ Delivery, siting, and all utilities connected
- ✓ Fully furnished throughout
- ✓ All kitchen appliances
- ✓ HD LED TVs throughout
- ✓ Digital TV aerial and satellite connection
- ✓ Manufacturer's Warranty
- ✓ Spacious, low maintenance composite decking with glass balustrading

Park Features & Benefits



- ✓ 5* Visit England graded park
- ✓ Full 12 month holiday season
- ✓ *The Bucket & Spade* bar and restaurant
- ✓ Indoor heated swimming pool
- ✓ Gym with cardio, resistance machines and free weights
- ✓ Wellness and beauty suite
- ✓ FREE golf at Teignmouth Golf Club

Benefits of Ownership

- ✓ Simple 'turnkey' holiday home ownership
- ✓ NO stamp duty to pay
- ✓ NO legal fees to pay
- ✓ A range of financing options including equity release, property part-exchange and Black Horse finance
- ✓ Fully managed letting service available
- ✓ Holiday at any time of year with no closed season



Why Choose Coast View

Situated on a hilltop, Coast View offers spectacular, uninterrupted views of the Jurassic Coast, peppered with luxury yachts and motorboats – making it the perfect place to unwind.

Nestled within the charming fishing village of Shaldon, you can treat yourself to some of the finest local wine-bars and restaurants that the West Country has to offer. A bit further afield, it's just a short drive to a host of attractions in nearby Dartmoor, Exeter and Torquay, so you can spend your time away discovering everything the Devon countryside and coast has to offer.

As an Owner at Coast View, you'll also have full use of our five-star leisure facilities, including a heated indoor swimming pool, fully equipped gym and Beauty & Wellness Suite, as well as indulge in delicious dining at our on-site bar, café and restaurant *The Bucket & Spade* – so no matter the weather, you can enjoy your holiday home and its gorgeous location.



Welcome to the Lakewood

Bringing the comfort of home to a spectacular setting, this spacious 2-bedroom holiday home allows you to relax and unwind with sumptuous interior décor at every turn.

With modern cool grey tones throughout the open-plan living room, the contemporary styling follows through to the large kitchen, which is then offset by beautiful light oak effect cupboards and parquet style flooring – providing the perfect entertainment space for family and friends.

Light floods through two large windows and twin patio doors which creates a large sense of space and provides the perfect platform to take in the stunning sea views. The Lakewood lodge is further enhanced by an incredibly thoughtful layout, providing an en-suite shower room to the master bedroom, a well-sized guest bedroom and plenty of storage throughout.



The Lodge Location

Our luxurious Lakewood Lodge is situated on our brand-new development, The Cove. Comprising of just four secluded plots, all benefit from spacious wraparound decking – perfect for effortless indoor/outdoor living. This stunning lodge also benefits from a 12-month holiday season, which means it can be enjoyed at any time of the year.



Key Features of this Lodge

- ✓ Distinctive front aspect with front French doors
- ✓ Inset panoramic log & flame effect electric fire
- ✓ Fully fitted kitchen with soft-close cupboards & drawers
- ✓ Integrated appliances incl. 5-burner gas hob, oven, microwave, dishwasher & fridge-freezer
- ✓ USB charging points in living & bedroom areas
- ✓ Luxurious walk-in wardrobe & shower en-suite to master bedroom

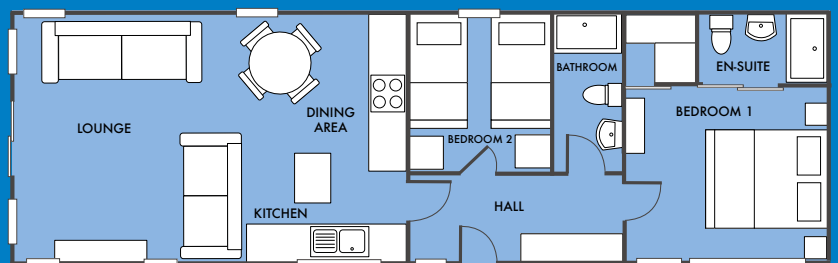

Important notice: These particulars do not form part of any offer or contract and must not be relied upon as statements or representations of fact. Any areas, measurements or distances are approximate. The text, photographs and plans are for guidance only and are not necessarily comprehensive.

All accommodation at Coast View is sold for HOLIDAY USE ONLY and must not be used as a primary place of residence. Evidence of a permanent address is required before purchasing and on-going annual checks of your permanent home address are a compulsory requirement of ownership.

For more information, or to arrange your personal viewing appointment, please call Shah on **01626 818250** or email: shah.rahman@swholidayparks.co.uk

